



BETA[®]

Stereo Zoom Microscope for precision inspection and manipulation tasks

- Wide range of magnification x2.1 - x160
- High resolution, high contrast images
- Modular design for easy addition of accessories
- Stereo optics for easy viewing and documenting of complex surfaces

The Beta stereo zoom microscope provides high quality viewing for both biomedical and industrial applications. The modular design makes for easy addition of accessories, enhancing system performance and flexibility.

Beta is used in a wide range of both industrial and life science applications, ranging from general manufacturing, medical devices, electronics, precision engineering, plastics and rubber to intricate life science work.

With a stereo magnification range from x7 - x40 (x160 maximum) and 5.7:1 zoom, Beta provides high performance stereo magnification in a robust design. The standard x1.0 objective provides 85mm working distance enabling easy sample manipulation, with options to increase magnification or increase working distance. With its modular construction, complete range of accessories and ergonomic design, Beta is suitable for almost any application from routine dissection to computer chip failure analysis and documentation.

Features and Benefits

- Incorporated modern advances in optical design allow your eyes and hands to work together resulting in increased throughput, accuracy and reduced scrap and rework.
- Wide magnification range of x2.1 - x160 provides clear, sharp images with long working distances and large depth of field.

Versatility

- Modular design allows for quick changeover of accessories and options. For example, from manipulation to high magnification inspection on to image capture.

Ergonomics

- Advanced design optimises ergonomic performance and provides superb hand-to-eye coordination for easy sample manipulation tasks.



Beta bench stand with integral substage illumination.

Stand Options

- Stable, focusable bench stand with subject holder, substage illumination and floating or measuring stage options.
- Adjustable, swing away, boom mount for mounting directly to user's work surface or with coated platform base for easy transport.

Crank handle option allows convenient vertical adjustment when frequent changes in working distance are required.



Beta, with swing away boom mount, for flexibility and ease of use.

Technical Data

Optical

- Afocal stereo zoom microscope provides a 26.4 field angle.
- Ergonomic design optimises head and body position for comfortable viewing.

Zoom Magnification (see table below)

- x7 - x40 multiplied by combinations of objective lenses and multipliers (total zoom magnification range x2.1 - x160).
- Zoom ratio 5.7:1
- Secondary multipliers x1.5 and x2.0
- Reducing objectives to increase working distance and field of view.
- Magnifying objectives to increase total magnification.

Illumination

- 12V/60W semi coaxial long life spot lamps.
- 6 or 10-point ringlight options with 21V/150W Halogen lamp.
- Substage illumination (bench stand only) 12V/20W Halogen lamp.
- Option of tilting substage illuminator to enhance contrast.



Beta, high quality viewing for biomedical applications.

Accessories

Oblique and Direct Viewer

- Allows the operator to view a subject from an angle of 34° from vertical, which can be rotated through to 360° enabling a better stereo view of 3-dimensional subjects including PCB solder joints, holes, pillars and thread forms. Both manual and motorised versions are available.



Oblique and direct viewer



Fixed angle viewer

Fixed Angle Viewer

- Allows the user three options; a fixed angle of 25° from vertical, the ability to view vertically or tilting the optical head and using the system standing up.

Ergowedge

- Allows the view to be adjusted between -5° and -25° from horizontal.



Ergowedge

Image Capture and Archive

Digital, USB and 35mm SLR cameras including Sony, Nikon, Pixera, Canon and other leading makes.

- Modular multimedia solutions for image archiving, acquisition, processing, analysis and documentation.



Image capture and archive

Step Magnification Multiplier

- Allows the stereo zoom range to be increased by a factor of x1.5 or x2.0 without any loss in working distance.



Step magnification multiplier

Measuring/Comparison Graticule

- Allows the user the ability to measure and compare against a scale. Standard range is available as a crossline or graduated scale. Custom graticules can be manufactured to specific designs.

| Objective Lens | Zoom Range | | | Working Distance | Field of View at Max. Zoom | | | Field of View at Min. Zoom | | |
|----------------|-------------|----------------------|----------------------|------------------|----------------------------|----------------------|----------------------|----------------------------|----------------------|----------------------|
| | | with x1.5 multiplier | with x2.0 multiplier | | | with x1.5 multiplier | with x2.0 multiplier | | with x1.5 multiplier | with x2.0 multiplier |
| x0.3* | x2.1 - x12 | x3.2 - x18 | x4.2 - x24 | 312mm | 15.3mm | 10.2mm | 7.6mm | 87.0mm | 58.0mm | 43.5mm |
| x0.5 | x3.5 - x20 | x5.3 - x30 | x7.0 - x40 | 177mm | 9.4mm | 6.3mm | 4.7mm | 53.5mm | 35.7mm | 27.2mm |
| x0.7 | x4.9 - x28 | x7.4 - x42 | x9.8 - x56 | 130mm | 6.7mm | 4.5mm | 3.4mm | 38.0mm | 25.3mm | 19.0mm |
| x1.0 | x7.0 - x40 | x10.5 - x60 | x14 - x80 | 85mm | 4.6mm | 3.0mm | 2.3mm | 26.2mm | 17.5mm | 13.1mm |
| x1.5 | x10.5 - x60 | x15.8 - x90 | x21 - x120 | 47mm | 3.2mm | 2.1mm | 1.6mm | 18.0mm | 12.0mm | 9.0mm |
| x2.0 | x14 - x80 | x21 - x120 | x28 - x160 | 29mm | 2.3mm | 1.5mm | 1.2mm | 13.3mm | 8.9mm | 6.6mm |

* when using the x0.3 objective lens with a bench stand model, an extended stand column is required to accommodate the increased working distance.

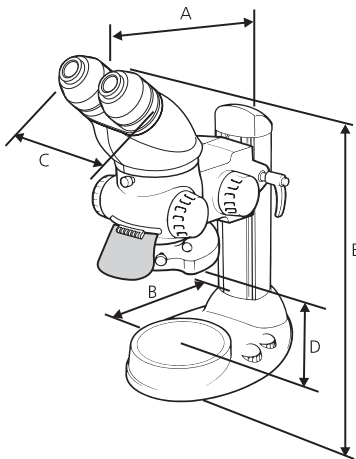

Beta Bench Stand

Bench Stand:

- A = 343mm
- B = 150mm
- C = 103 - 123mm
- D = 120mm
- E = 410mm

Unpacked weight: 9.5kg
Packed weight: 13.0kg

Boom Mount:

- F = 400mm maximum
- G = 310mm less working distance
- H = 440mm

Unpacked weight: 17.0kg
Packed weight: 20.0kg

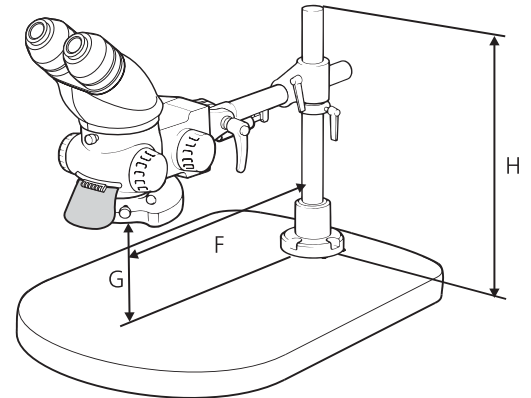

Beta Boom Mount

For more information...

Vision Engineering has a network of offices and technical distributors around the world. For more information, please contact your Vision Engineering branch, local authorised distributor, or visit our website.

Vision Engineering Ltd.
(Manufacturing)
Send Road, Send, Woking,
Surrey, GU23 7ER, England
Tel: +44 (0) 1483 248300
Fax: +44 (0) 1483 223297
Email: generalinfo@visioneng.com

Vision Engineering Inc.
(Manufacturing & Commercial)
570 Danbury Road, New Milford,
CT 06776 USA
Tel: +1 (860) 355 3776
Fax: +1 (860) 355 0712
Email: info@visioneng.com

Vision Engineering Ltd.
(Central Europe)
Anton-Pendele-Str. 3,
D-82275, Emmering, Germany
Tel: +49 (0) 8141 40167-0
Fax: +49 (0) 8141 40167-55
Email: info@visioneng.de

Vision Engineering Ltd.
(France)
1 Rue de Terre Neuve, ZA Courtaboeuf,
91967 Les Ulis Cedex, France
Tel: +33 (0) 164 46 90 82
Fax: +33 (0) 164 46 31 54
Email: info@visioneng.fr

Vision Engineering Ltd.
(Commercial)
Monument House, Monument Way West,
Woking, Surrey, GU21 5EN, England
Tel: +44 (0) 1483 248300
Fax: +44 (0) 1483 248301
Email: generalinfo@visioneng.com

Vision Engineering Inc.
(Commercial West Coast USA)
745 West Taft Avenue, Orange,
CA 92865 USA
Tel: +1 (714) 974 6966
Fax: +1 (714) 974 7266
Email: info@visioneng.com

Nippon Vision Engineering
(Japan)
272-2 Saedo-cho, Tsuduki-ku,
Yokohama-shi, 224-0054, Japan
Tel: +81 (0) 45 935 1117
Fax: +81 (0) 45 935 1177
Email: info@visioneng.jp

Vision Engineering Ltd.
(Italy)
Via Cesare Cantù, 9
20092 Cinisello Balsamo MI, Italy
Tel: +39 02 6129 3518
Fax: +39 02 6129 3526
Email: info@visioneng.it

Distributor

Visit our multi-lingual website:

www.visioneng.com